

THE NEXT GENERATION
OF 3D PRINTING
IS HERE

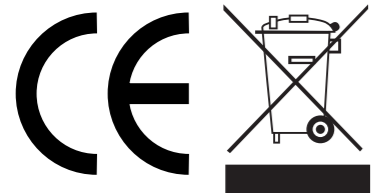

DISPOSAL INSTRUCTIONS

Do not throw this electronic device into the waste when discarding. To minimize pollution and ensure utmost protection of the global environment, please recycle or return to Photocentric for recycling.

UK
Cambridge House, Oxney Road
Peterborough PE1 5YW UK.
info@photocentric.co.uk
www.photocentricgroup.com

USA
2205 West Parkside Lane, Phoenix,
85027, AZ USA

Photocentric
CURE M

PHOTOCENTRIC CURE M USER MANUAL

Photo**o**centric
CURE M

THANK YOU FOR PURCHASING THE PHOTOCENTRIC CURE M, THIS DEVICE HAS BEEN DEVELOPED TO OFFER YOU THE OPTIMAL METHOD OF POST CURING SMALL TO MEDIUM SIZED PARTS. THE COMBINATION OF HEAT AND UV THAT THE CURE M OFFERS MAKES IT THE IDEAL COMPANION TO YOUR LIQUID CRYSTAL PRINTER.

Good Work...

Custom Prg: **75**

UV

MID

TIME

60°C

TIME

00:40

Save

let's get to know it...

SAFETY RULES



Warning: This oven uses UV LED light sources of high energy UV rays can cause serious harm to health, especially for eye and skin; so avoid direct or indirect exposure to such emissions even for short periods of time.



Warning: Even though the Cure M oven is equipped with an automatic switch off system on the UV LEDs we do advise caution and to not accidentally or intentionally open the door during use. If during the process you need to open the door, pause the programme using the interface before opening the device.



Warning: The safety systems on the CURE M are intended as emergency aids: do not try tamper in any way with the integrity of the UV oven or any part thereof. Please do not tamper with the closed-lid control system. In case of a malfunction of the system or in case of incorrect lighting of the LEDs with the door open, immediately remove the power plug from the outlet and contact technical support.



Warning: The CURE M is powered by a 220V mains voltage, avoid tampering with the parts of the equipment to avoid the risk of electrocution. In case of malfunction of the device contact technical support.



Warning: The CURE M has a touchscreen interface and does not use commands or mechanical buttons. For this reason, even when the oven is not in use please turn off to prevent damage. Disconnect power to the CURE M each time it is not used for long periods, especially if left unattended.



Warning: Keep hands and fingers clear when closing the lid of the CURE M unit.

Photocentric declines all responsibility for incorrect use or improper use of its products.



Warning: CURE M utilizes the heat generated by the LEDs to accelerate the drying process of the resins, The treated objects and the oven itself may be very hot.



Warning: CURE M uses the heat generated by the LEDs for accelerate the drying process of the resin, do not leave the CURE M unattended to avoid risk of fire.



Warning: The resins during polymerization can generate a lot of heat, especially if collected in large quantities. Never leave the CURE M unattended to avoid the risk of fire.



Warning: The printed parts that are placed to dry within the CURE M can generate fumes that are harmful volatile substances to your health. Position and use the CURE M in a well-ventilated place.



Warning: The fan located on the CURE M has the task of controlling the temperature of the device through numerous air vents placed at different points of the CURE M. Do not obstruct these air vents or the opening to the fan itself, if these are obstructed, they can cause damage to the CURE M itself.



Warning: The CURE M is a device for professional use. Keep in a safe place, accessible only to qualified technicians who follow these instructions. Do not allow children to use this device.



Warning: Place CURE M away from heat sources, away from flammable materials and liquids that may cause risk to the safety of the device. Do not wet, wipe with a dry cloth.

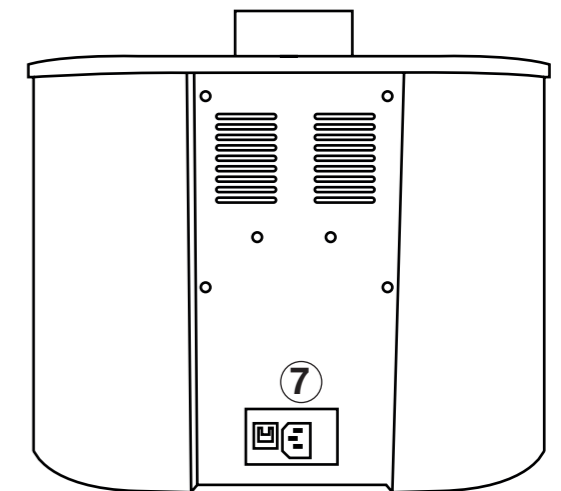
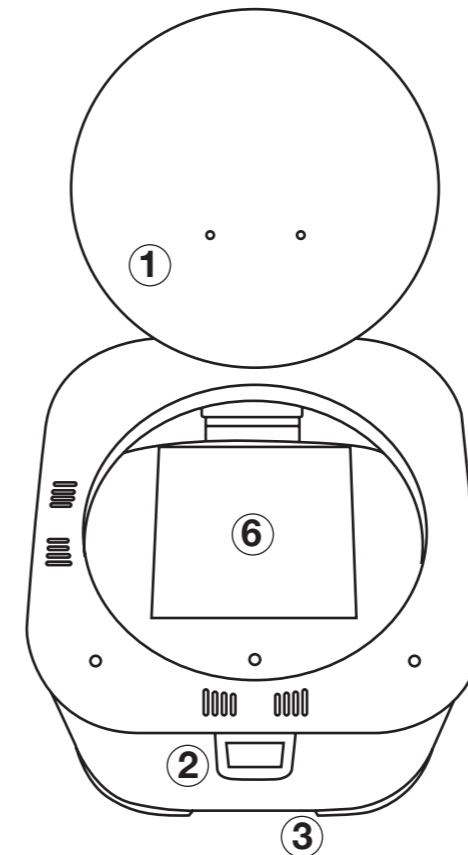

- 1 Drying compartment lid
- 2 Display Touch screen
- 3 Fan air output connection
- 4 Power supply 3A Fuse
UK, EU + US plug included
- 5 Support Plate (with 4 rubber supports)
- 6 Curing
- 7 Mains

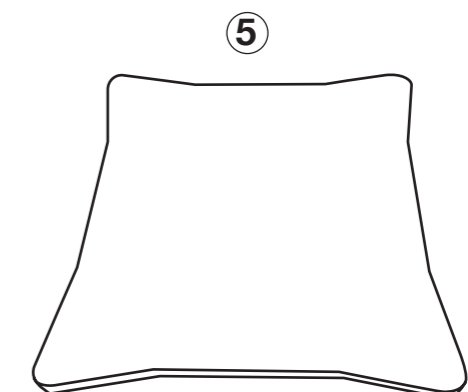
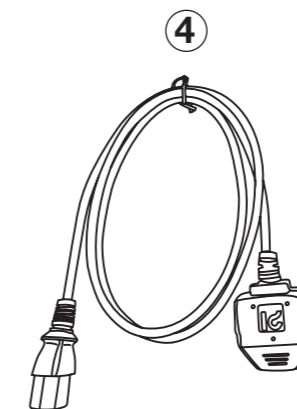

FIRST START

 **WARNING:** Carefully read the safety notes.

1. Be careful when opening the packaging: Do not use a sharp blade that could damage the contents.
2. Remove the CURE M from the box by lifting upwards.
3. Remove the foam panels from the top.
4. Keep the packaging, this guarantees safe transport of the CURE M.
5. Put the CURE M on a secure surface; pay attention to place it at a distance of at least 10 cm from any other object, including the back wall. This procedure is essential in order to not obstruct the vents of the CURE M's cooling system. (See safety regulations)
6. Connect the power supply cable into both the CURE M and a power outlet. You can use a controlled switch outlet to disconnect the power to the oven in an easy manner when not in use. (See safety regulations).
7. After connecting the CURE M to the power a brief start-up screen will appear and then go into stand-by mode.

Warning: in this mode the CURE M is ready to start the required program, it does not emit UV rays but remains connected to the mains. (See safety regulations)

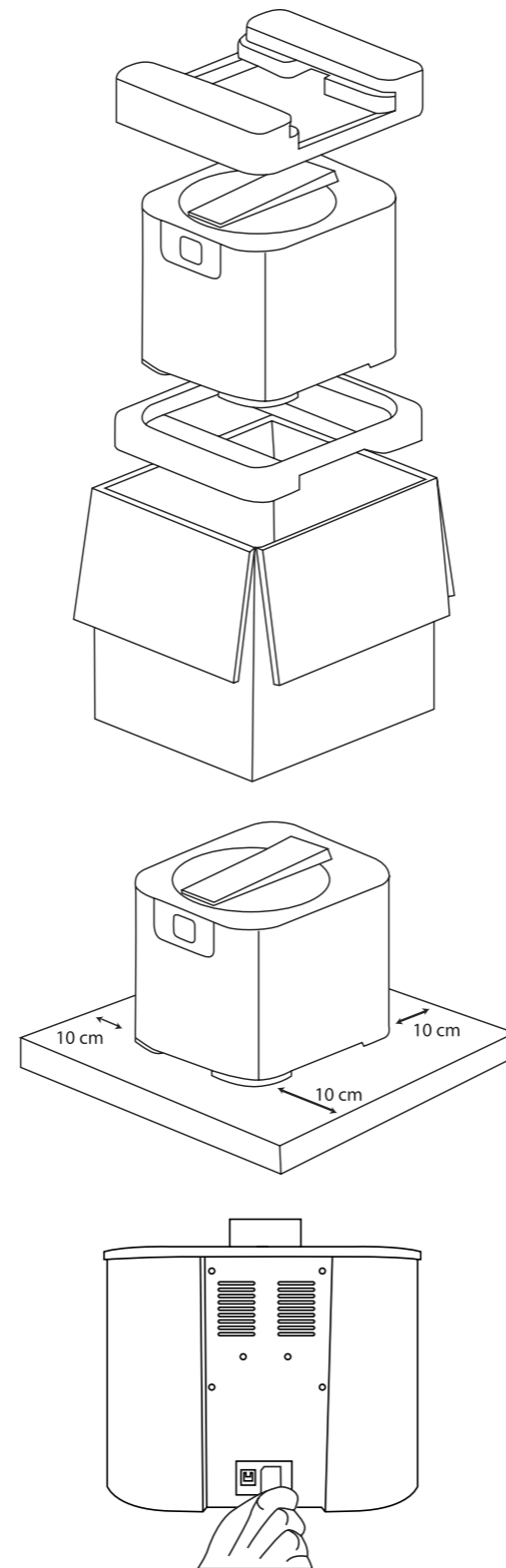

PROGRAMS

The CURE M system has a microprocessor controlled touch-screen interface and intuitive software that allows you to control every aspect of the drying process of your resin objects.

The CURE M system has three drying programs: two for standard use to finalize small and large products, and a third called Custom that allows you to create a customized program for curing your resin. All three programs use the controlled emission of several very powerful 405nm and 365nm UV LEDs and the accelerating effect of heat, thanks to the thermoregulation system. The multiple action of the many UV emitters allows the 360° irradiation of the piece without having to rotate it.

Standard programs

From the power-on screen, it automatically switches to the program screen. In this condition the oven is powered and ready to start the program chosen by the user.

Clear Program

The Clear program is designed for drying objects produced with transparent and delicate resins. The UV emission is reduced to 10% and the exposure time is 20 minutes. The program starts by clicking on the CLEAR icon.

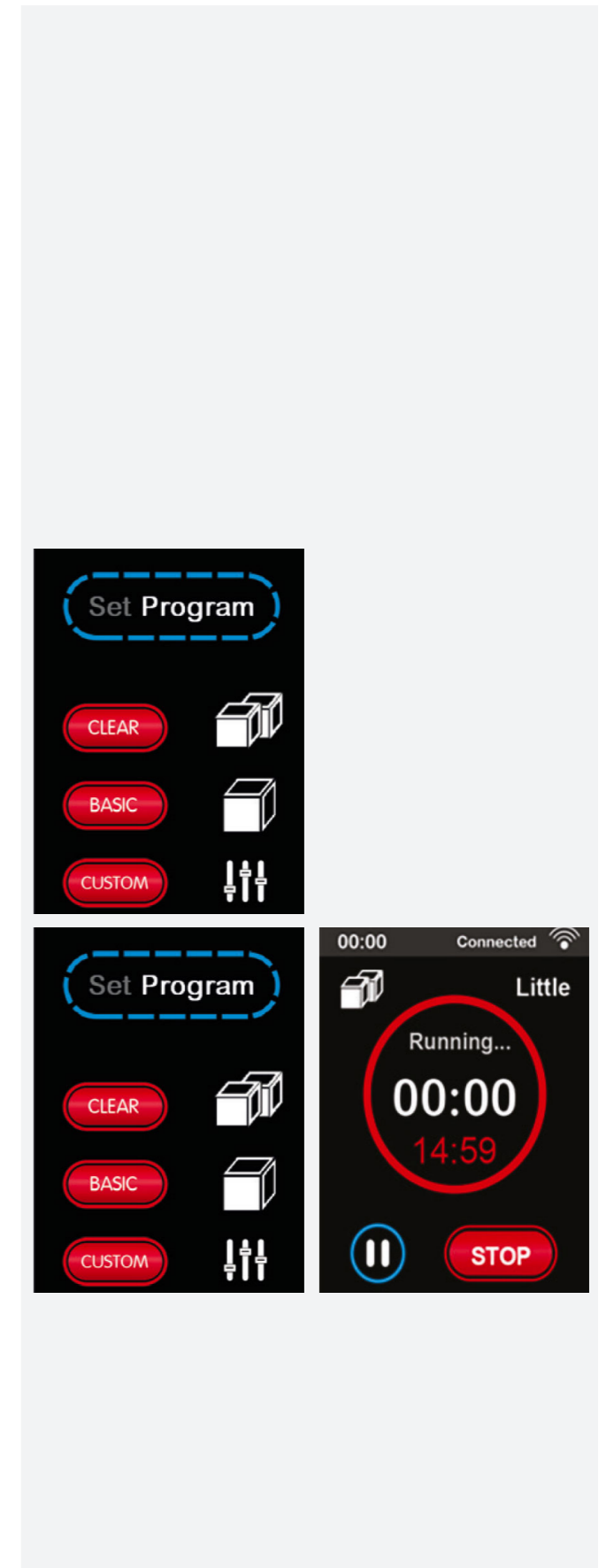

Program : Basic

The Big program is designed for drying large objects that take up most of the drying volume. The UV emission is 100% of its power and the exposure time is 90 minutes. The temperature curve will reach 40 ° C during the program. The program starts by clicking on the BIG icon on the icon.

The program Custom and memorization

The Photocentric Cure M can store 7 personalized programs (0-6) within its user interface.

The Custom programs will allow you to save your most used polymerization processes without having to enter the values into the CURE M each time. The Custom program also allows you perform the below:

Adjust UV power from 1% up to 100%.

Adjust the exposure time from 1 second to 100 hours. The temperature from 20 ° C to 60 ° C (which will be reached during the program).

Clear Program.

The Clear program is designed for drying objects produced with transparent and delicate resins. The UV emission is reduced to 10% and the exposure time is 20 minutes. The program starts by clicking on the CLEAR icon.

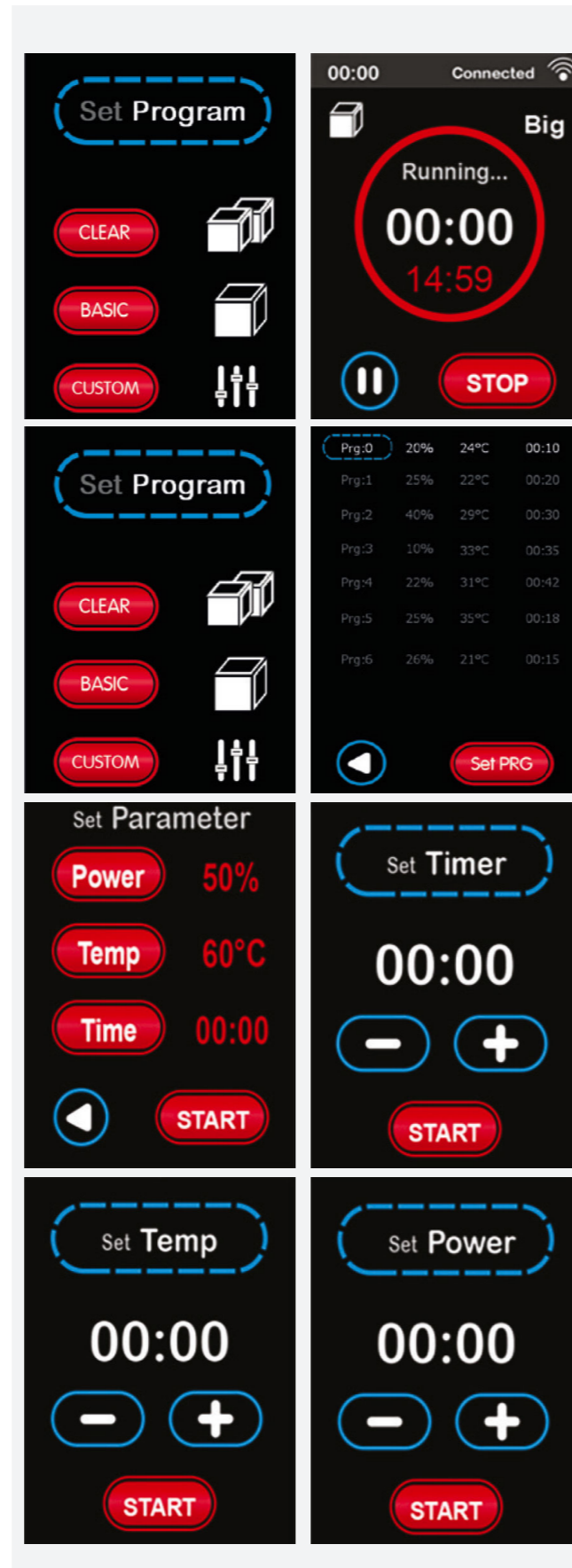

Storing a program

Click on Custom and display the program list choose the number of the program you want to edit and save, once the program has been selected click on Set PRG and set the parameters you want and return to the program list.

Check that the program shows the values you have set by clicking again on the set program and then start the program with START.

During the program you can stop it by clicking on STOP or put it in PAUSE. At the end of the process the display will indicate the process is complete.

Caution:

Only if you return to the program list will yours be stored if you select.

Start after changing programs without returning to the program list.

It will be valid only for that work cycle and will not be stored.

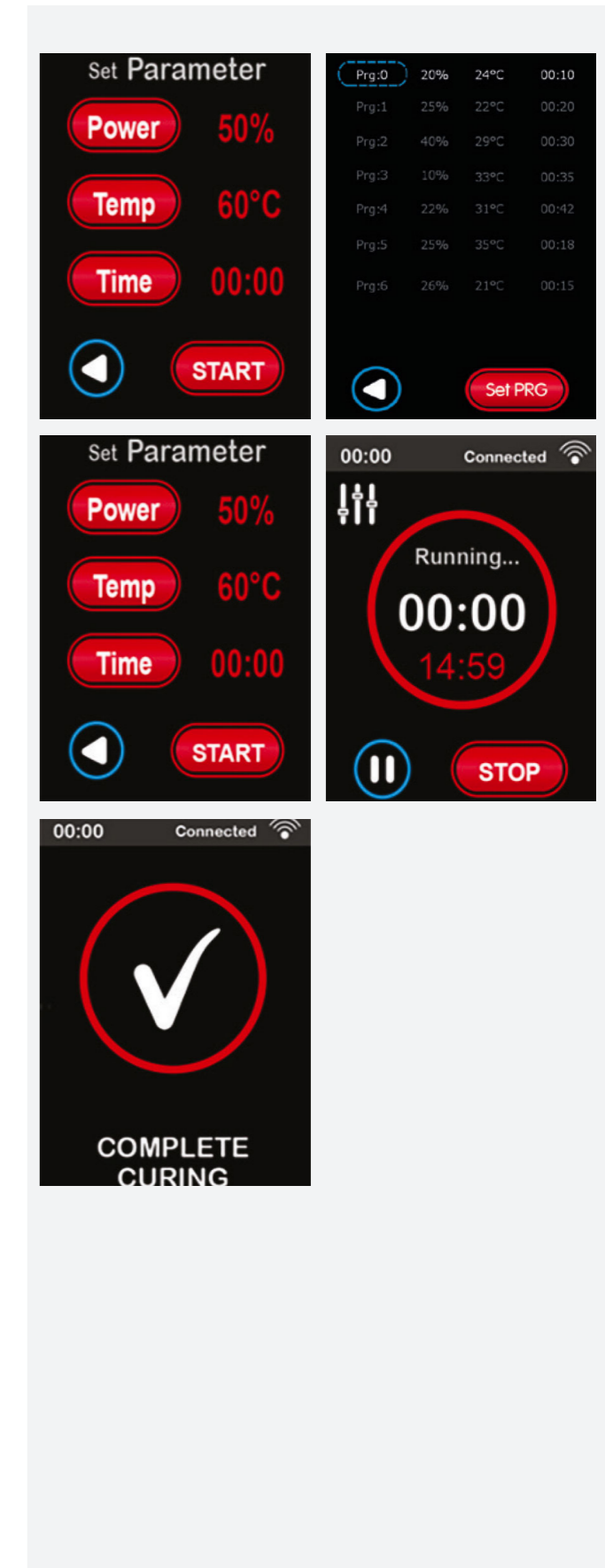

Wifi connection

To connect the product to your WIFI you have to place the product next to a PC with a WIFI connection. Click on the WIFI symbol located at the top right of the display.

On the display you will see the connection procedure. Click on start WIFI AP and from your PC access the Wifi network called "PhocentricCUREMWIFI".

To connect the product to your Wifi line you have to place the product next to a PC with Wifi connection. Click on the Wifi symbol located at the top right of the display. When the connection is established, open the browser and go to the link: <http://191.168.1.1/wifi>

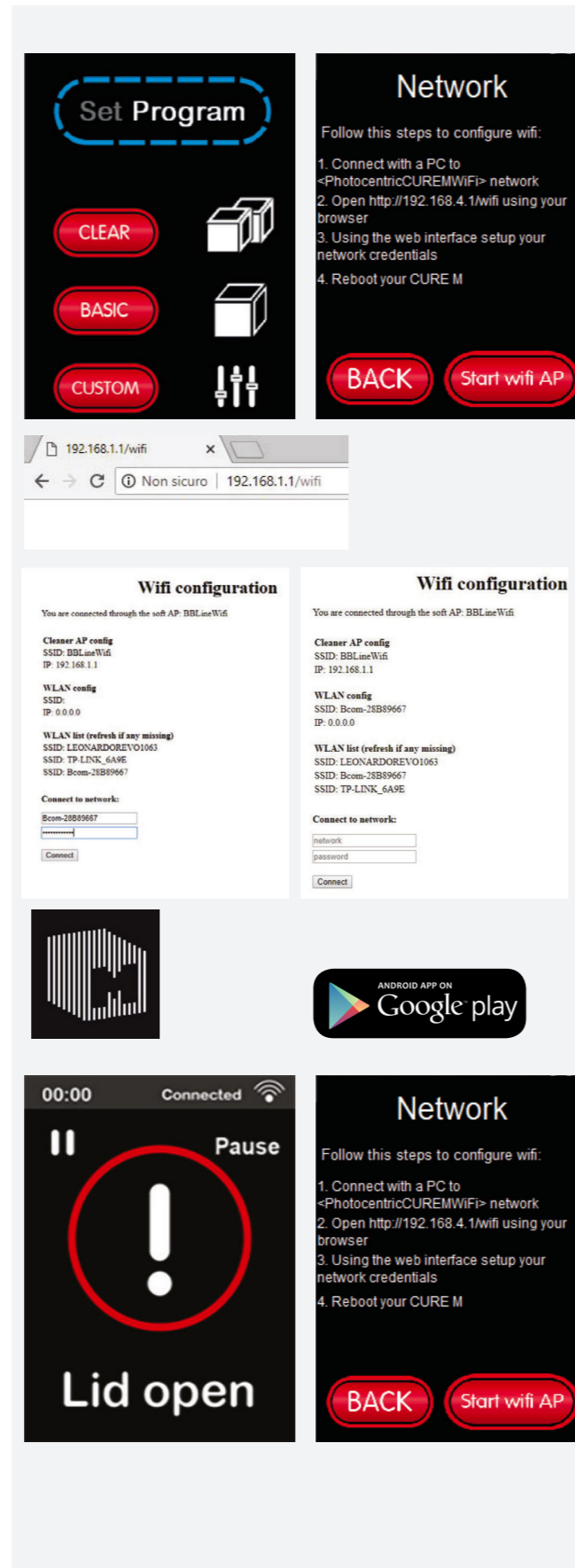

Alarms

The lid should never be opened during the execution of a program of polymerization. For this reason there are pause and stop keys on each screen. However the CURE M does have a system of Automatic emergency shut-off connected to the cover. In case of accidental opening of the cover the LEDs will stop working and a screen will appear alarm (see right).

If the LEDs do not switch off immediately remove the power to the oven and contact technical support. The CURE M also has a protection system to prevent overheating: in case of an excessive increase in temperature the oven will react by blocking every activity, the LEDs will stop working until the temperature drops to an acceptable level.

MAINTENANCE

If the CURE M does not turn on, check that the power cord is inserted correctly in the power socket and in the plug in the rear panel.

ENVIRONMENTAL OPERATING CONDITIONS

Keep CURE M in a ventilated place away from sources of heat, away from flammable materials and liquids that may cause a safety risk. Keep the Cure M at least 20cm away from the wall. Do not obstruct in any way the pipes, their openings to the outside and the fans on the rear panel and on the bottom to avoid damaging the CURE M itself. Keep CURE M in an environment with temperatures of 18 °C to 28 ° C.

TECHNICAL FEATURES

- External dimensions: 355x410x550
- Curing chamber dimensions: 200x200x200
- Emitter type: hi-power LED 5W
- Number of emitters: 30
- Irradiance system: OmniRay 360 °Irradiance
- Wavelengths: 2
- Emission centralization: $\lambda 1$ 365nm - $\lambda 2$ 405nm
- Emission opening: +/- 20nm
- Total emitter power: 150W
- Emission control: 16 bit PWM control Heating System: Eco-passive
- Heating control: 6x PID controller
- Management: 16bit IDM processor
- Interface: 3.2" TFT
- Programs : 2 standard - custom set n°7 memory
- Command : Auto off
- Touch screen: Yes
- Connectivity: 2.4Ghz WiFi
- Power supply: Inside
- Power supply voltage: 110/220 3A 50-60Hz

DIMENSIONS

